

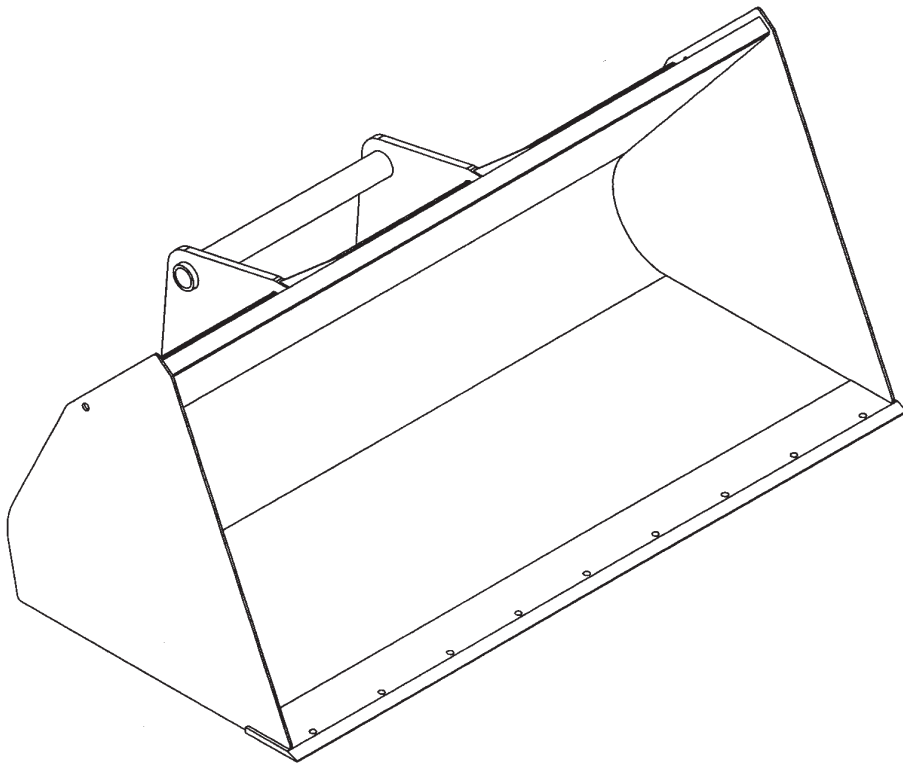

BUCKET MANUAL FOR CT-SERIES TELESCOPIC HANDLERS OPERATOR'S & PARTS MANUAL



MODEL NUMBER: _____

Manual Number: 76266

SERIAL NUMBER: _____

Revision: 3

MANUFACTURED BY PALADIN BRANDS FOR GEHL
143 Water Street
West Bend, WI 53095

Printed in U.S.A.

TABLE OF CONTENTS

To The Owner	3
Limited Warranty	5
Safety Statements	7
General Safety Precautions.....	7-9
Equipment Safety Precautions	10
Installation & Operation	11
1.00 Cubic Yards x 73" Wide General Purpose Bucket Assembly #820252	
Exploded View and Parts List.....	12
1.50 Cubic Yards x 73" Wide Light Material Bucket Assembly #820254	
Exploded View and Parts List.....	13
Bolt-On Cutting Edge Assembly #820255 For 73" Wide General Purpose Bucket	
Exploded View and Parts List.....	14
1.25 Cubic Yards x 96" Wide General Purpose Bucket Assembly #820258	
Exploded View and Parts List.....	15
2.00 Cubic Yards x 96" Wide Low Profile Bucket Assembly #820277	
Exploded View and Parts List.....	16
2.50 Cubic Yards x 96" Wide Light Material Bucket Assembly #820256	
Exploded View and Parts List.....	17
3.25 Cubic Yards x 96" Wide Bucket Assembly #820278	
Exploded View and Parts List.....	18
Bolt-On Cutting Edge Assembly #820259 For 96" Wide General Purpose Bucket	
Exploded View and Parts List.....	19

GENERAL INFORMATION

Congratulations on the purchase of your new attachment. Your attachment was carefully designed and manufactured to give you many years of dependable service. Be sure to observe all safety precautions in this manual and in the equipment operator's manual. Always check load charts before operating.

ABOUT THIS MANUAL

Read this manual before using your attachment. This manual has been designed to help you do a better and safer job. Remember, never let anyone operate this equipment without reading the "Safety Precautions" and "Operating Instructions" in the equipment manuals. All operators should be fully trained and judged to be competent by an experienced, qualified person who has full knowledge of the "Safety Precautions" and "Operating Instructions."

SERVICE

When servicing your attachment, remember to use only original manufacturer's replacement parts. Substitute parts may not meet the standards required for safe, dependable operation.

To facilitate parts ordering, record the model and serial number of your attachment in the space provided on the front of this manual. This information may be obtained from the identification plate located on the left side of the attachment.

Your parts department needs this information to ensure that you receive the correct parts for your specific attachment. When calling the Gehl Parts Department, please specify that these are parts for a Paladin attachment.

For price and availability, contact:
Gehl Parts Department
Tel (262) 334-6653, Option #1

Limited Warranty

The manufacturer warrants all new products to be free from defects in material and/or workmanship for a period of twelve (12) months. Under no circumstances will it cover any merchandise or components thereof, which, in the opinion of the manufacturer, have been subject to misuse, unauthorized applications, modifications, alteration, an accident or if repairs have been made with parts other than those obtainable through the manufacturer.

In the event of failure within the warranty period from initial retail sale, first lease or rental date (excluding cable, ground engaging parts such as sprockets, digging chain, bearings, teeth, tamping and demolition heads, blade cutting edges, pilot bits, auger teeth, auger heads, and broom brushes). If after examination, the manufacturer determines failure was due to defective material and/or workmanship, part(s) will be repaired or replaced. The manufacturer may request defective part(s) be returned prepaid to them for inspection at their place of business at Delhi, Iowa, or to a location specified by them.

Limitations on Responsibility

THIS WARRANTY IS IN LIEU OF ALL OTHER WARRANTIES, EXPRESSED OR IMPLIED AND THERE ARE NO WARRANTIES OF MERCHANTABILITY OR OF FITNESS FOR A PARTICULAR PURPOSE . IN NO EVENT SHALL THE MANUFACTURER BE LIABLE FOR CONSEQUENTIAL OR SPECIAL DAMAGE.

THE MANUFACTURER'S LIABILITY FOR ANY AND ALL LOSSES AND DAMAGES TO BUYER, RESULTING FROM ANY CAUSE WHATSOEVER, INCLUDING THE MANUFACTURER'S NEGLIGENCE, IRRESPECTIVE OF WHETHER SUCH DEFECTS ARE DISCOVERABLE OR LATENT, SHALL IN NO EVENT EXCEED THE PURCHASE PRICE OF THE PARTICULAR PRODUCTS WITH RESPECT TO WHICH LOSSES OR DAMAGES ARE CLAIMED, OR, AT THE ELECTION OF THE MANUFACTURER, THE REPAIR OR REPLACEMENT OF DEFECTIVE OR DAMAGED PRODUCTS.

SAFETY STATEMENTS



THIS SYMBOL BY ITSELF OR WITH A WARNING WORD THROUGHOUT THIS MANUAL IS USED TO CALL YOUR ATTENTION TO INSTRUCTIONS INVOLVING YOUR PERSONAL SAFETY OR THE SAFETY OF OTHERS. FAILURE TO FOLLOW THESE INSTRUCTIONS CAN RESULT IN INJURY OR DEATH.



DANGER

THIS SIGNAL WORD IS USED WHERE SERIOUS INJURY OR DEATH WILL RESULT IF THE INSTRUCTIONS ARE NOT FOLLOWED PROPERLY.



WARNING

THIS SIGNAL WORD IS USED WHERE SERIOUS INJURY OR DEATH COULD RESULT IF THE INSTRUCTIONS ARE NOT FOLLOWED PROPERLY.



CAUTION

THIS SIGNAL WORD IS USED WHERE MINOR INJURY COULD RESULT IF THE INSTRUCTIONS ARE NOT FOLLOWED PROPERLY.

NOTICE

NOTICE INDICATES A PROPERTY DAMAGE MESSAGE.

GENERAL SAFETY PRECAUTIONS

WARNING!



READ MANUAL PRIOR TO INSTALLATION

Improper installation, operation, or maintenance of this equipment could result in serious injury or death. Operators and maintenance personnel should read this manual, as well as all manuals related to this equipment and the telescopic handler thoroughly before beginning installation, operation, or maintenance. **FOLLOW ALL SAFETY INSTRUCTIONS IN THIS MANUAL AND THE TELESCOPIC HANDLER'S MANUAL(S).**



READ AND UNDERSTAND ALL SAFETY STATEMENTS

Read all safety decals and safety statements in all manuals prior to operating or working on this equipment. Know and obey all OSHA regulations, local laws, and other professional guidelines for your operation. Know and follow good work practices when assembling, maintaining, repairing, mounting, removing, or operating this equipment.



KNOW YOUR EQUIPMENT

Know your equipment's capabilities, dimensions, and operations before operating. Visually inspect your equipment before you start, and never operate equipment that is not in proper working order with all safety devices intact. Check all hardware to ensure it is tight. Make certain that all locking pins, latches, and connection devices are properly installed and secured. Remove and replace any damaged, fatigued, or excessively worn parts. Make certain all safety decals are in place and are legible. Keep decals clean, and replace them if they become worn or hard to read.

M-909 7-28-05

GENERAL SAFETY PRECAUTIONS - CONTINUED

WARNING!



PROTECT AGAINST FLYING DEBRIS

Always wear proper safety glasses, goggles, or a face shield when driving pins in or out, or when any operation causes dust, flying debris, or any other hazardous material.

WARNING!



LOWER OR SUPPORT RAISED EQUIPMENT

Do not work under raised booms without supporting them. Do not use support material made of concrete blocks, logs, buckets, barrels, or any other material that could suddenly collapse or shift positions. Make sure support material is solid, not decayed, warped, twisted, or tapered. Lower boom to ground level or on blocks. Lower boom and attachments to the ground before leaving the cab or operator's station.

WARNING!



USE CARE WITH HYDRAULIC FLUID PRESSURE

Hydraulic fluid under pressure can penetrate the skin and cause serious injury or death. Hydraulic leaks under pressure may not be visible. Before connecting or disconnecting hydraulic hoses, read your prime mover's operator's manual for detailed instructions on connecting and disconnecting hydraulic hoses and fittings.

- Keep unprotected body parts, such as face, eyes, and arms as far away as possible from a suspected leak. Flesh injected with hydraulic fluid may develop gangrene or other permanent disabilities.
- If injured by injected fluid, see a doctor at once. If your doctor is not familiar with this type of injury, ask him to research it immediately to determine proper treatment.
- Wear safety glasses, protective clothing, and use a piece of cardboard or wood when searching for hydraulic leaks. **DO NOT USE YOUR HANDS! SEE ILLUSTRATION.**

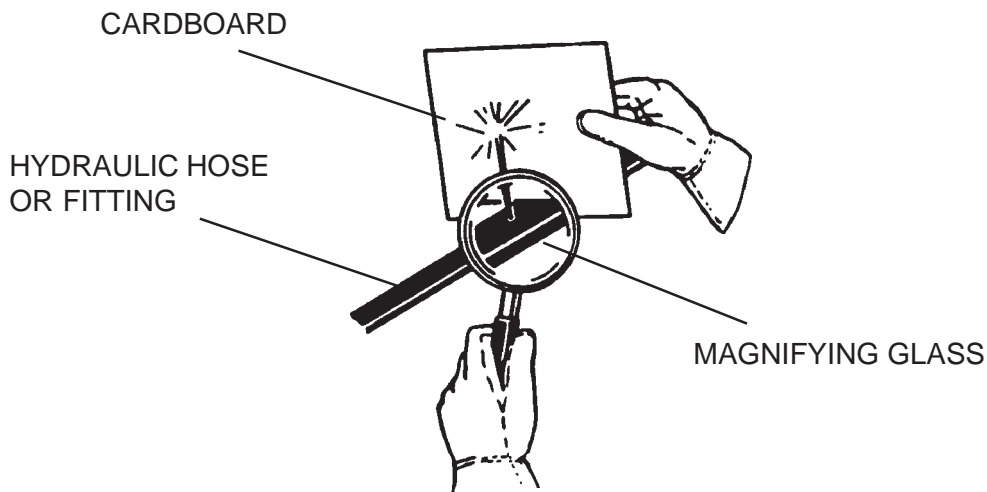

GENERAL SAFETY PRECAUTIONS - CONTINUED

WARNING!



DO NOT MODIFY MACHINE OR ATTACHMENTS

Modifications may weaken the integrity of the attachment and may impair the function, safety, life, and performance of the attachment. When making repairs, use only the manufacturer's genuine parts, following authorized instructions. Other parts may be substandard in fit and quality. Never modify any ROPS (Roll-Over Protection Structure) or FOPS (Falling Object Protective Structure) equipment or device. Any modifications must be authorized in writing by the manufacturer.

WARNING!



SAFELY MAINTAIN AND REPAIR EQUIPMENT

- Do not wear loose clothing or any accessories that can catch in moving parts. If you have long hair, cover or secure it so that it does not become entangled in the equipment.
- Work on a level surface in a well-lit area.
- Use properly grounded electrical outlets and tools.
- Use the correct tools for the job at hand. Make sure they are in good condition for the task required.
- Wear the protective equipment specified by the tool manufacturer.



SAFELY OPERATE EQUIPMENT

Do not operate equipment until you are completely trained by a qualified operator in how to use the controls, know its capabilities, dimensions, and all safety requirements. See your machine's manual for these instructions.

- Keep all step plates, grab bars, pedals, and controls free of dirt, grease, debris, and oil.
- Never allow anyone to be around the equipment when it is operating.
- Do not allow riders on the attachment or the telescopic handler.
- Do not operate the equipment from anywhere other than the correct operator's position.
- Never leave equipment unattended with the engine running, or with the attachment in a raised position.
- Do not alter or remove any safety feature from the telescopic handler or the attachment.
- Know your work site safety rules as well as traffic rules and flow. When in doubt on any safety issue, contact your supervisor or safety coordinator for an explanation.

EQUIPMENT SAFETY PRECAUTIONS

WARNING!



KNOW WHERE UTILITIES ARE

Observe overhead electrical and other utility lines. Be sure equipment will clear them. When digging, call your local utilities for location of buried utility lines, gas, water, and sewer, as well as any other hazard you may encounter.



OPERATING THE TELESCOPIC HANDLER

Avoid steep hillside operation, which could cause the telescopic handler to overturn. Consult your machine's operator's and safety manuals for maximum incline allowable. Extreme caution should be used when working along the top of banks or slopes. Keep away from the edge.

When operating on a slope, keep the load low, and proceed with extreme caution. Do not drive ACROSS a steep slope - drive straight up and down. With a LOADED bucket - drive with the bucket and load facing uphill. With an EMPTY bucket - drive with the bucket facing downhill.



WORKING WITH THE ATTACHMENT

- Never use the attachment for a work platform or personnel carrier.
- Specified lift capacities must not be exceeded, otherwise machine stability will not be sufficient. Always observe lift capacity limits listed in the machine specifications or on load charts furnished with the telescopic handler.
- An operator must not use drugs or alcohol, which can change his or her alertness or coordination. An operator taking prescription or over-the-counter drugs should seek medical advice on whether or not he or she can safely operate equipment.
- Always check locking pins before operating any attachment.
- Never lift, move, or swing a loaded bucket over anyone.
- Never undercut a high bank. When working at the base of a bank, overhang, or stockpile, avoid dangers such as rock or earth slides, overhanging trees, or a cave-in, by proper job operation.
- Be careful when handling loose objects. Lifting objects too high, or rolling the bucket too far back, could result in the objects sliding backward down the boom onto the operator's compartment.
- Don't obstruct your vision when traveling or working. Carry the bucket low for maximum stability and visibility.



MAINTAINING THE ATTACHMENT

- Never perform any work on the equipment unless you are authorized and qualified to do so. Always read the operator's and service manual(s) before any repair is made. After completing the maintenance or repair, check for correct functioning of the attachment. If not functioning properly, always attach a "DO NOT OPERATE" tag to the machine until all problems are corrected.
- Worn, damaged, or illegible safety decals must be replaced. New safety decals can be ordered from the manufacturer.

M-912 6-28-05

INSTALLATION AND OPERATION

ATTACHING AND DETACHING EQUIPMENT

Please see your machine's operator's manual for instructions on attaching and detaching equipment.

OPERATING EQUIPMENT

Read all Safety Precautions before operating a new attachment. If you have not been supplied with a load chart for the attachment, order one from your dealer, and place it inside the operating machine for safe lift capacity limits.

Refer to the machine operator's manual for attachment operation.

NOTE: A cutting edge assembly is recommended when operating on hard abrasive surfaces.

GENERAL PURPOSE BUCKET ASSEMBLY #820252
1.00 CUBIC YARDS - 73" WIDE

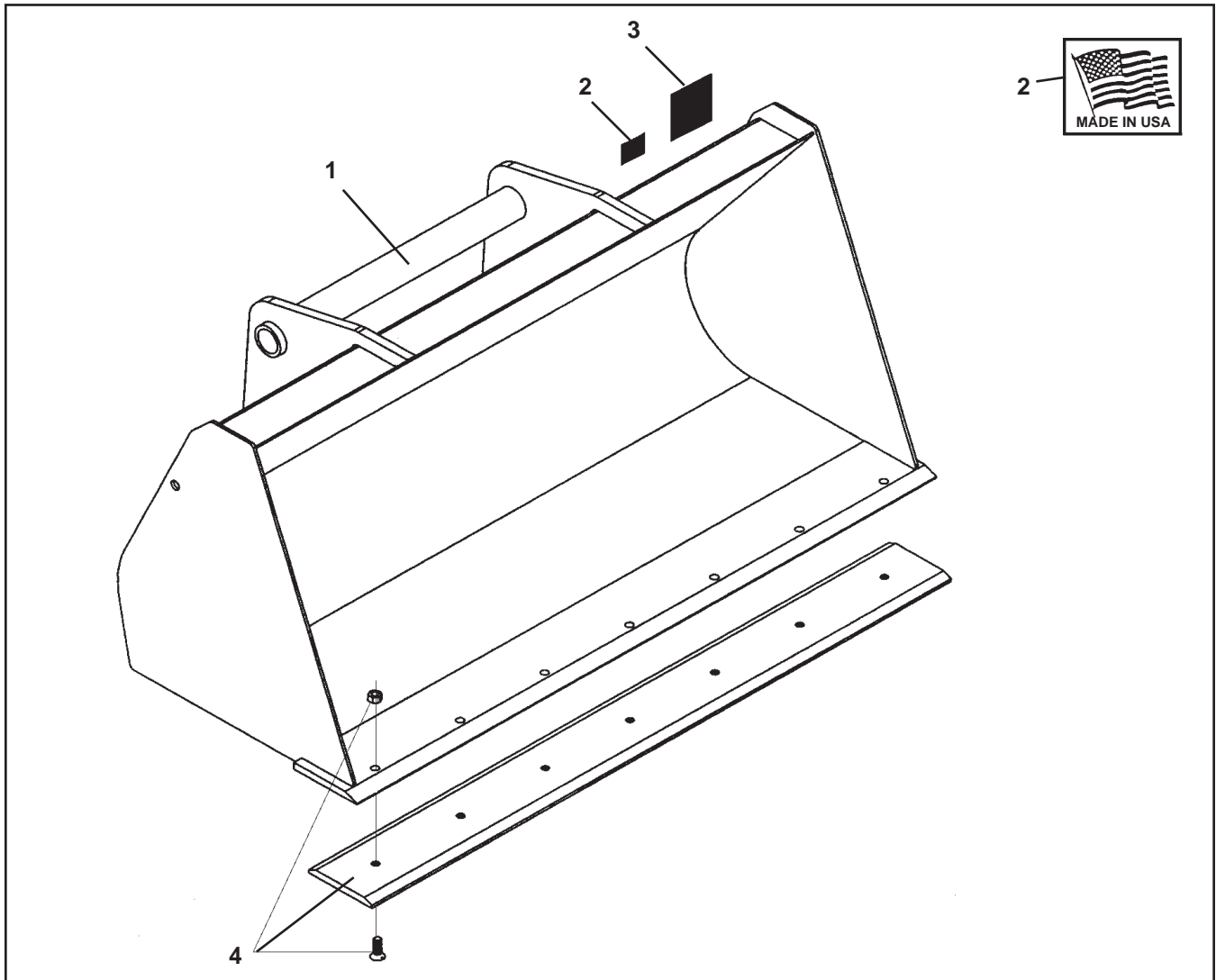

ITEM	PART NUMBER	QTY	DESCRIPTION
1	104850	1	Bucket, 1.00 Cubic Yard x 73" Wide
2	4338	1	Made In USA Decal
3	---	1	Serial Number Identification Tag Location
4	820255	1	Bolt-On Cutting Edge Assembly
	100830	1	.75" x 8.00" x 74" Cutting Edge
	1937	7	.75" UNC x 2.50" Plow Bolt, Grade 5
	1936	7	.75" UNC Deformed Lock Nut

NOTE: Please specify that this is a Paladin attachment when contacting the Gehl Parts Department.

M-941 10-29-07-2

LIGHT MATERIAL BUCKET ASSEMBLY #820254
1.50 CUBIC YARDS - 73" WIDE

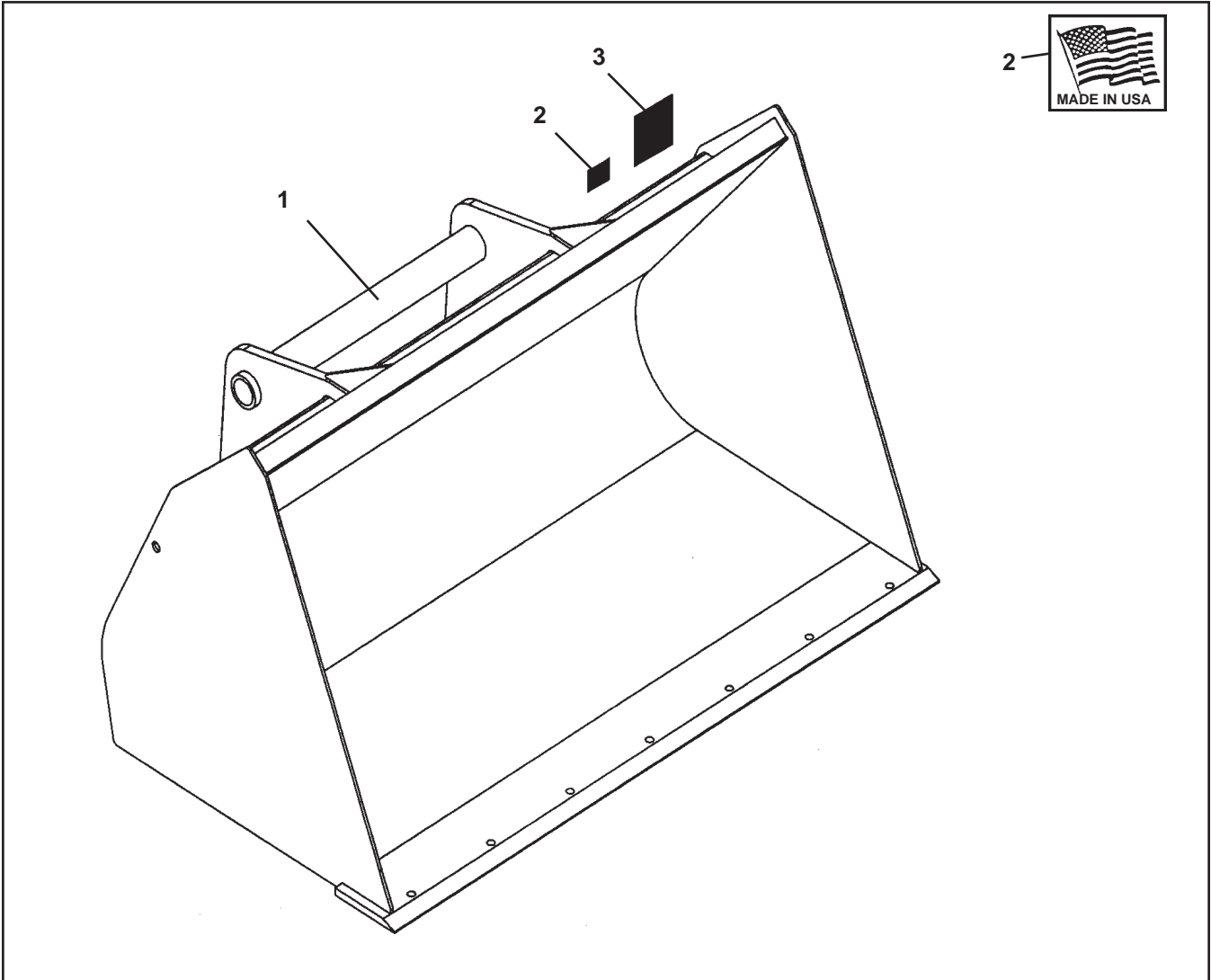

ITEM	PART NUMBER	QTY	DESCRIPTION
1	104849	1	Bucket, 1.50 Cubic Yards x 73" Wide
2	4338	1	Made In USA Decal
3	---	1	Serial Number Identification Tag Location

NOTE: Please specify that this is a Paladin attachment when contacting the Gehl Parts Department.

**BOLT-ON CUTTING EDGE ASSEMBLY #820255
FOR 73" WIDE GENERAL PURPOSE BUCKET**

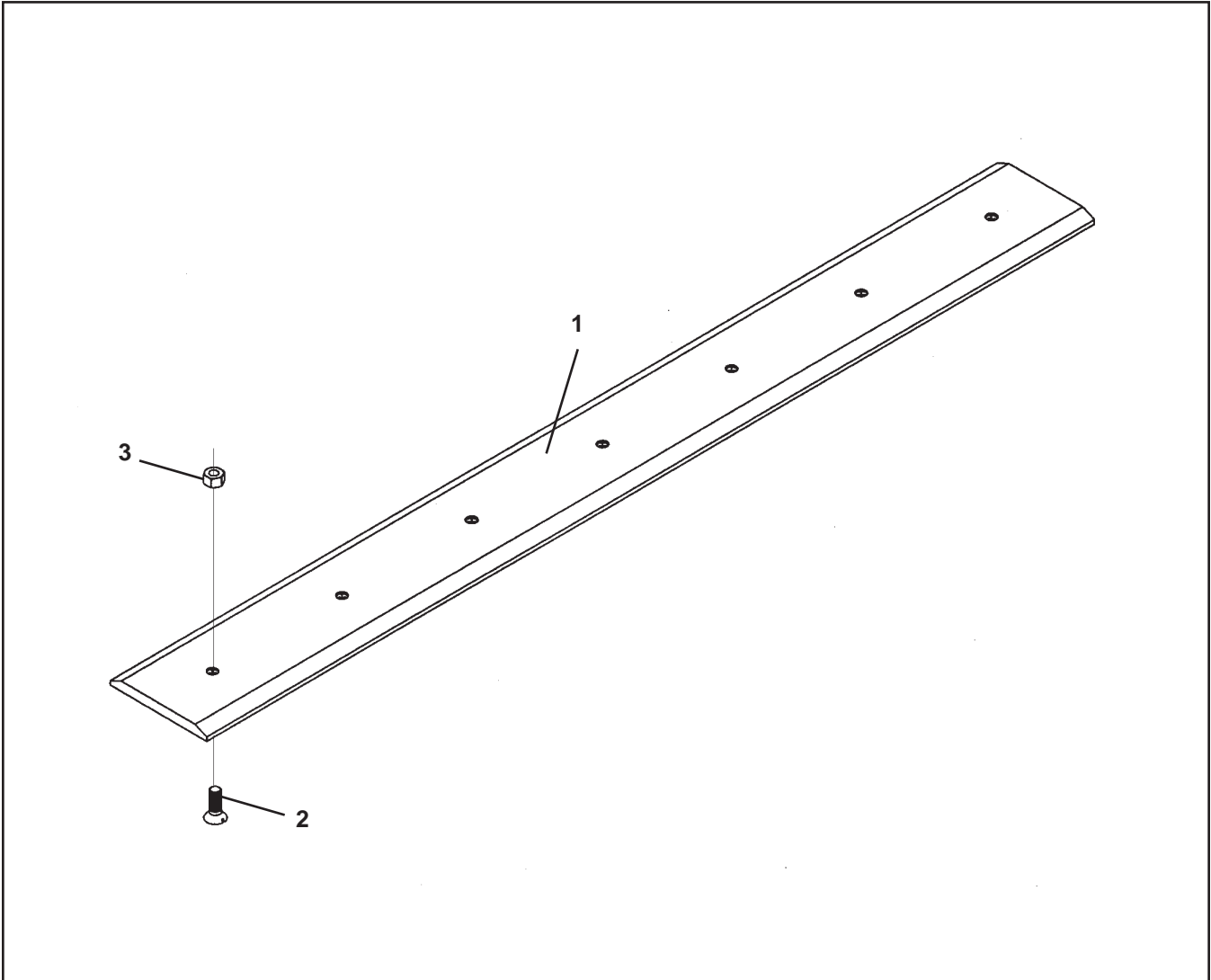

ITEM	PART NUMBER	QTY	DESCRIPTION
	820255	1	Bolt-On Cutting Edge Assembly
1	100830	1	.75" x 8.00" x 74" Cutting Edge
2	1937	7	.75" UNC x 2.50" Plow Bolt, Grade 5
3	1936	7	.75" UNC Deformed Lock Nut

NOTE: Please specify that this is a Paladin attachment when contacting the Gehl Parts Department.

GENERAL PURPOSE BUCKET ASSEMBLY #820258
1.25 CUBIC YARDS - 96" WIDE

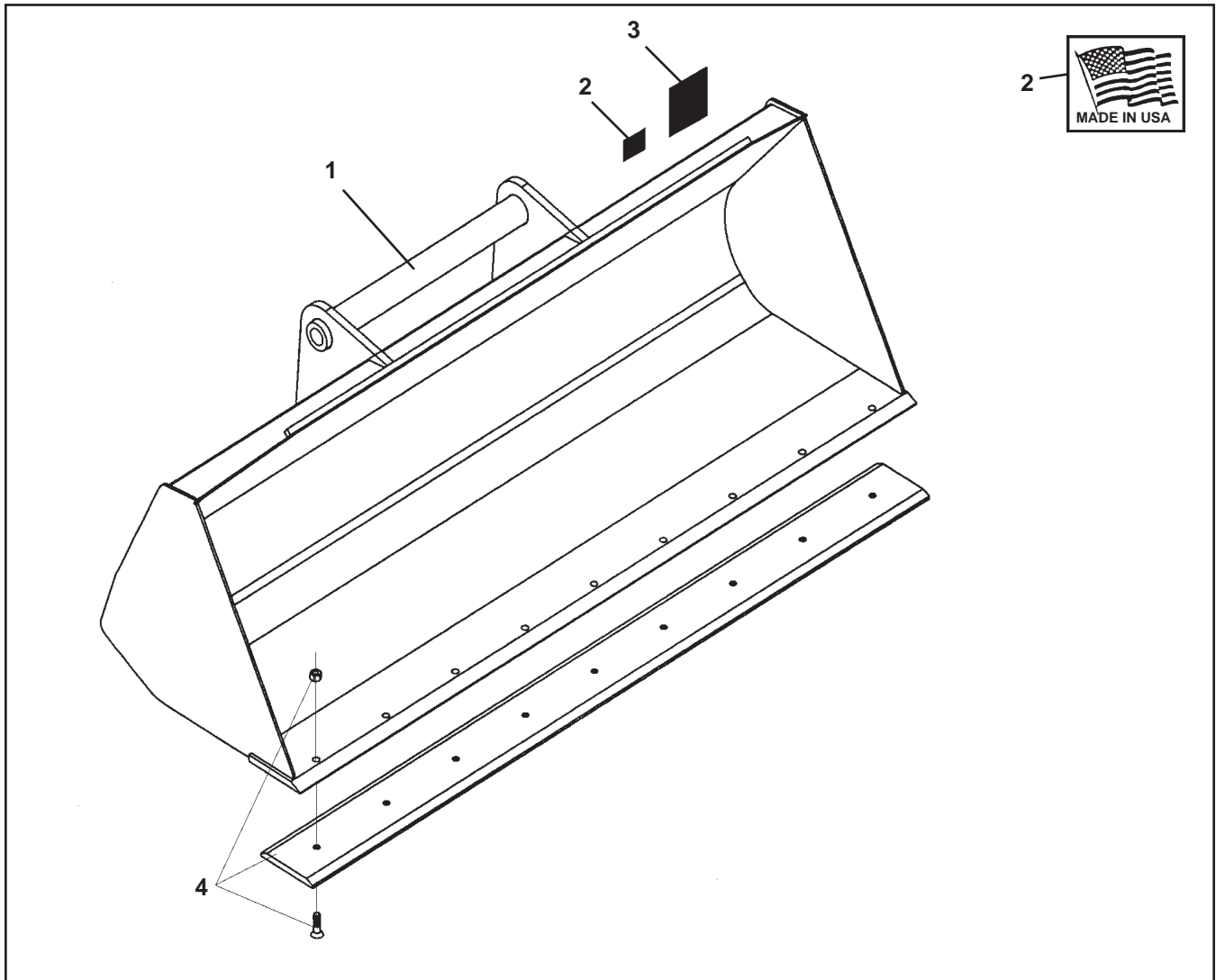

ITEM	PART NUMBER	QTY	DESCRIPTION
1	104782	1	Bucket, 1.25 Cubic Yard x 96" Wide
2	4338	1	Made In USA Decal
3	---	1	Serial Number Identification Tag Location
4	820259	1	Bolt-On Cutting Edge Assembly
	12245	1	.75" x 8.00" x 96" Cutting Edge
	1937	9	.75" UNC x 2.50" Plow Bolt, Grade 5
	1936	9	.75" UNC Deformed Lock Nut

NOTE: Please specify that this is a Paladin attachment when contacting the Gehl Parts Department.

M-925 10-30-07-2

LOW PROFILE BUCKET ASSEMBLY #820277
2.00 CUBIC YARDS - 96" WIDE

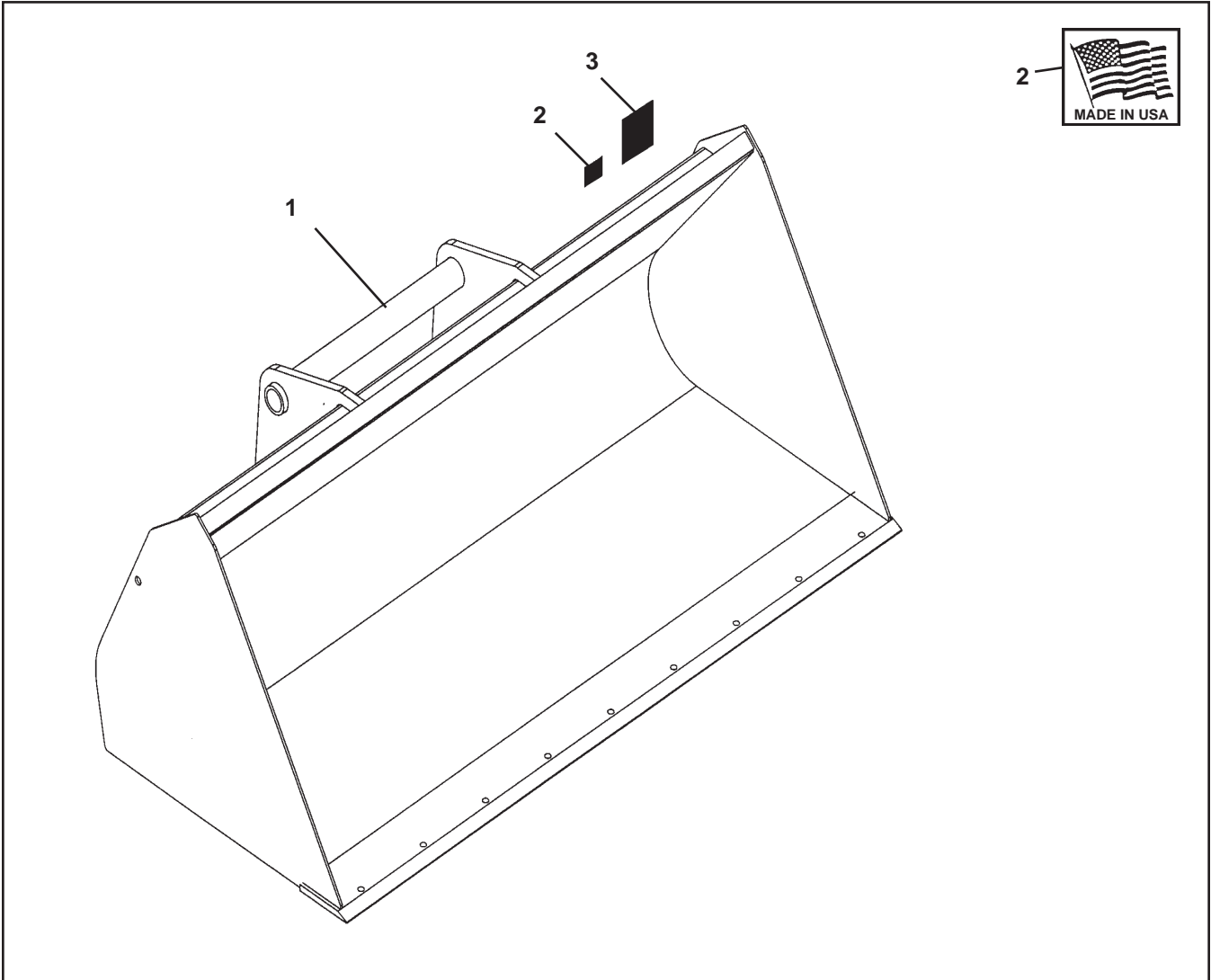

ITEM	PART NUMBER	QTY	DESCRIPTION
1	105749	1	Bucket, 2.00 Cubic Yards x 96" Wide
2	4338	1	Made In USA Decal
3	---	1	Serial Number Identification Tag Location

NOTE: Please specify that this is a Paladin attachment when contacting the Gehl Parts Department.

LIGHT MATERIAL BUCKET ASSEMBLY #820256
2.50 CUBIC YARDS - 96" WIDE

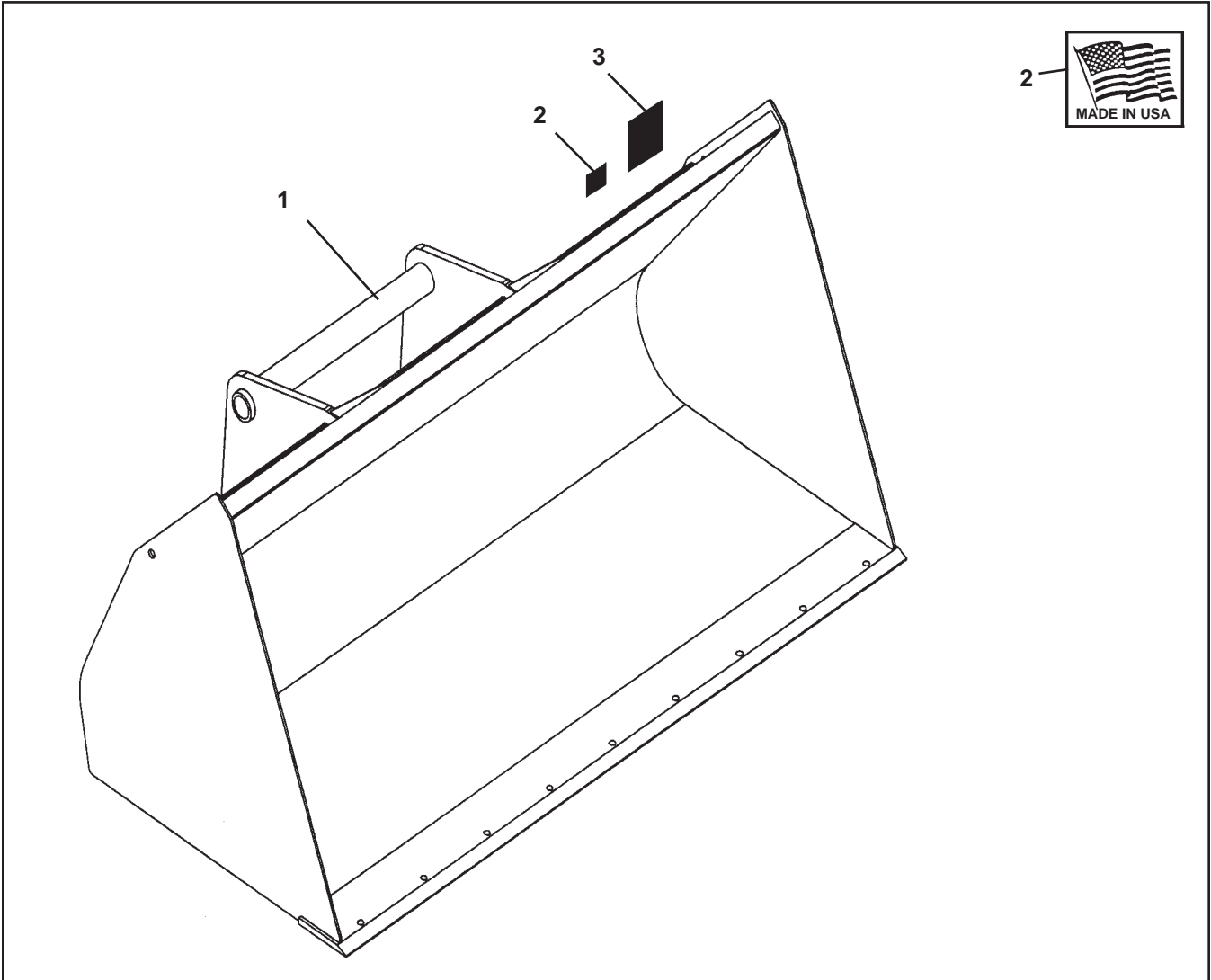

ITEM	PART NUMBER	QTY	DESCRIPTION
1	104661	1	Bucket, 2.50 Cubic Yards x 96" Wide
2	4338	1	Made In USA Decal
3	---	1	Serial Number Identification Tag Location

NOTE: Please specify that this is a Paladin attachment when contacting the Gehl Parts Department.

BUCKET ASSEMBLY #820278
3.25 CUBIC YARDS - 96" WIDE

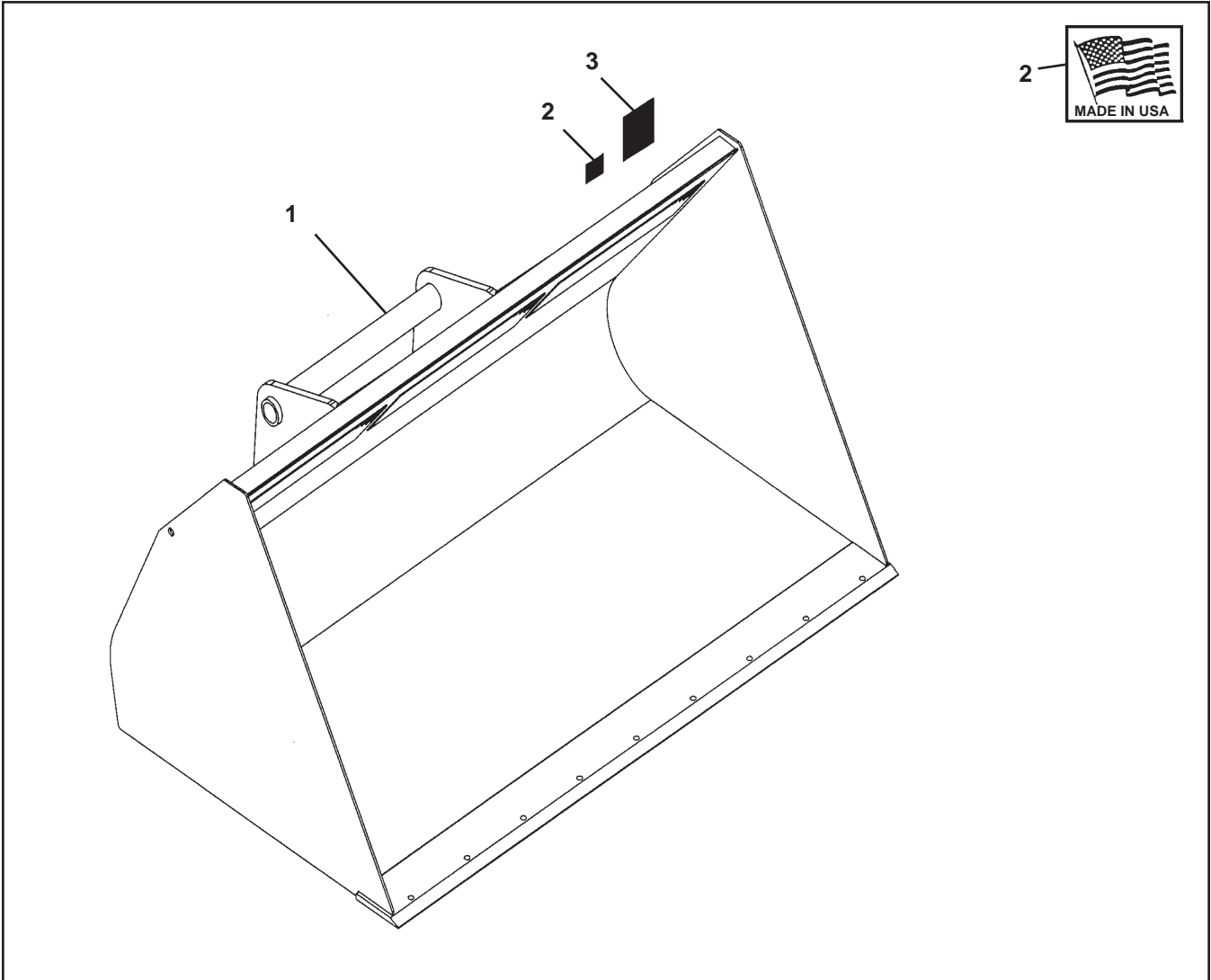

ITEM	PART NUMBER	QTY	DESCRIPTION
1	316831	1	Bucket, 3.25 Cubic Yards x 96" Wide
2	4338	1	Made In USA Decal
3	---	1	Serial Number Identification Tag Location

NOTE: Please specify that this is a Paladin attachment when contacting the Gehl Parts Department.

**BOLT-ON CUTTING EDGE ASSEMBLY #820259
FOR 96" WIDE GENERAL PURPOSE BUCKET**

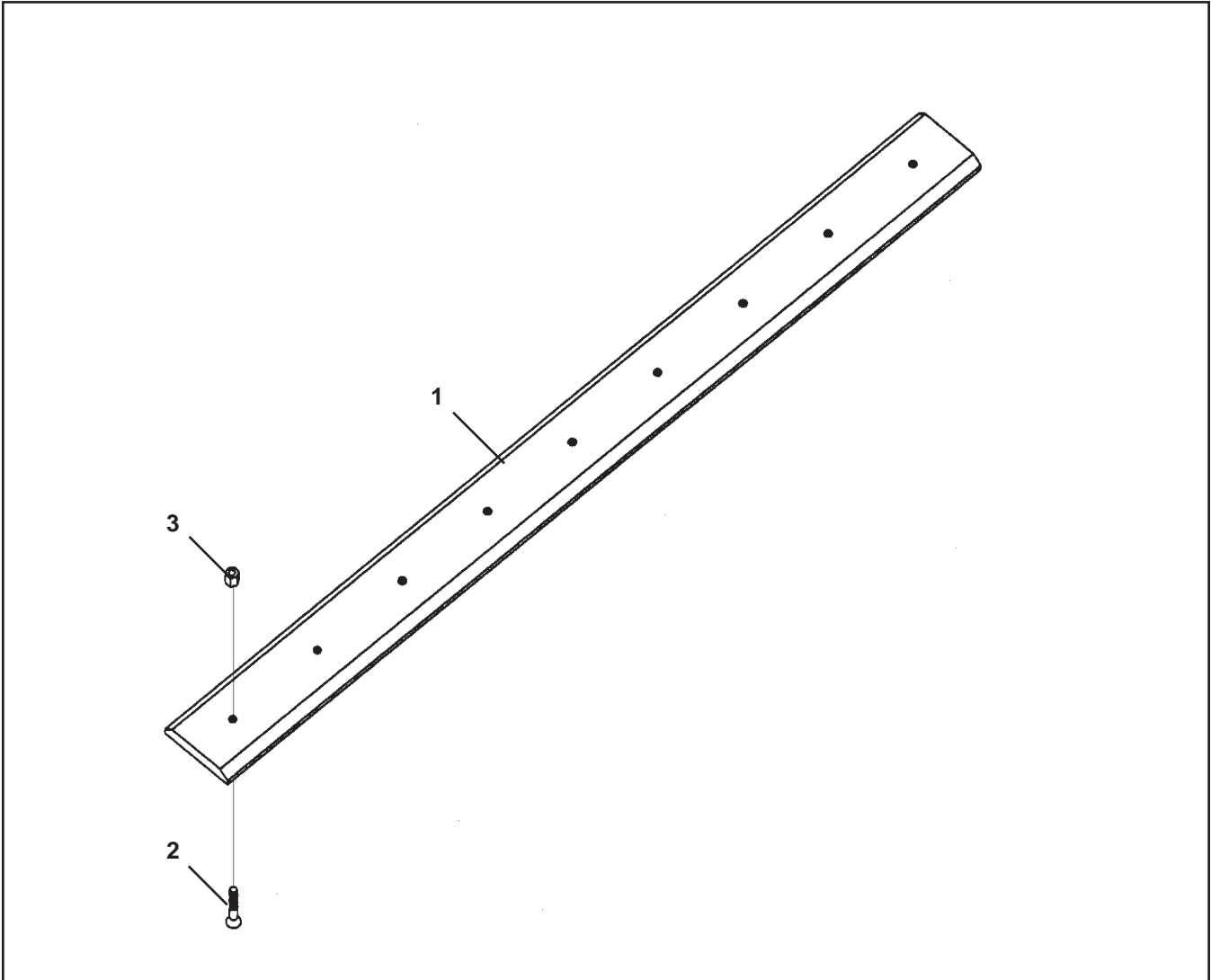

ITEM	PART NUMBER	QTY	DESCRIPTION
	820259	1	Bolt-On Cutting Edge Assembly
1	12245	1	.75" x 8.00" x 96" Cutting Edge
2	1937	9	.75" UNC x 2.50" Plow Bolt, Grade 5
3	1936	9	.75" UNC Deformed Lock Nut

NOTE: Please specify that this is a Paladin attachment when contacting the Gehl Parts Department.